

## Adjustable Stove Guard™

0089

**Caution:** Be sure stove is turned off and is room temperature prior to installation.

**Step1: Clean stove surface**

Thoroughly clean off stove surface where Stove Guard is being applied using a cloth and a degreasing cleanser. Allow to dry.

**Step2: Apply Stove Guard tape to clips**

Peel off one side of the paper lining from Stove Guard tape to expose the adhesive and apply to the underside of each Clip (three total).

**Step3: Attach clips to Stove Guard**

Attach one clip to center section of Part "A". Then attach the two remaining clips on the ends of Parts "B". Next, slide Part "B" into each end of Part "A" and adjust length to fit your stove.

**Step4: Attach Stove Guard**

Peel off remaining paper lining to expose adhesive on underside of each clip. Carefully locate Stove Guard on surface where it is being installed and press firmly in place.

**Important:** Install with a minimum distance of 1.5" (4cm) from stove burners.

Remove Guard sections and leave only clips installed overnight to insure proper bonding. A warm stove will also help initial bonding.

**Caution:** To avoid damage, it may be necessary to remove Stove Guard before using a broiler or "Self Cleaning" feature of some lower ovens. This Stove Guard device provides a temporary deterrent for infants and toddlers from burns caused by reaching the surface of cooking area of the kitchen stove, and does not replace parental responsibility for supervision of children when cooking.

**Note:** To order an additional clip kit (three clips and tape) for \$3.75, or just additional tape for \$1.75, please contact Prince Lionheart, Inc. directly or mail a check or money order. (CA residents please add 7.75% sales tax).

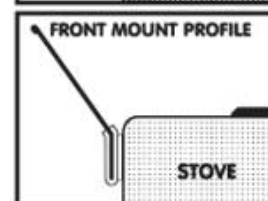
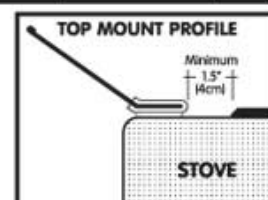
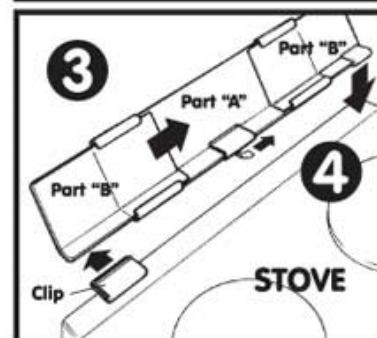
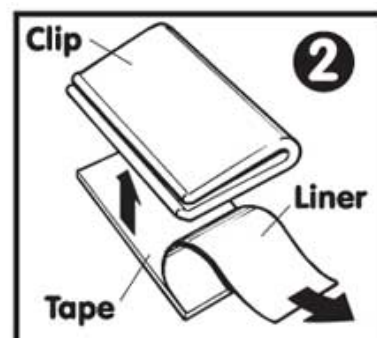

Corporate Headquarters  
Prince Lionheart, Inc.  
2421 S. Westgate Road  
Santa Maria, CA 93455  
USA



Europe  
Prince Lionheart UK Ltd.  
4 Sovereign Park  
Coronation Road  
London NW10 7QP, England



[Print](#)



[Download](#)